

6.0 TAPSCOTT STREET ALIGNMENT - EXISTING

Blue dashed line indicates extent of site plan shown to the right

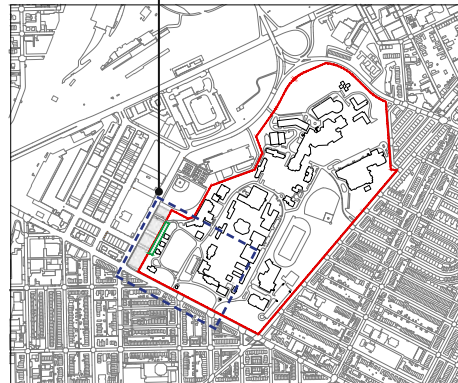

KEY

1. House 1
2. Ballard House
3. Fay House
4. Denison House
5. Kellogg Conference Center
6. Peikoff Alumni House
7. Peet Hall
8. EMG Memorial Building
9. College Hall
10. Chapel Hall
11. Dawes House
12. Fowler Hall
13. Gate Lodge
14. Olmsted Green
15. Appleby Building
16. 6th Parking Garage

A. Existing Tapscott St Access

B. Existing Service Access to Kellogg Hotel



0' 20' 40' 80' 120'

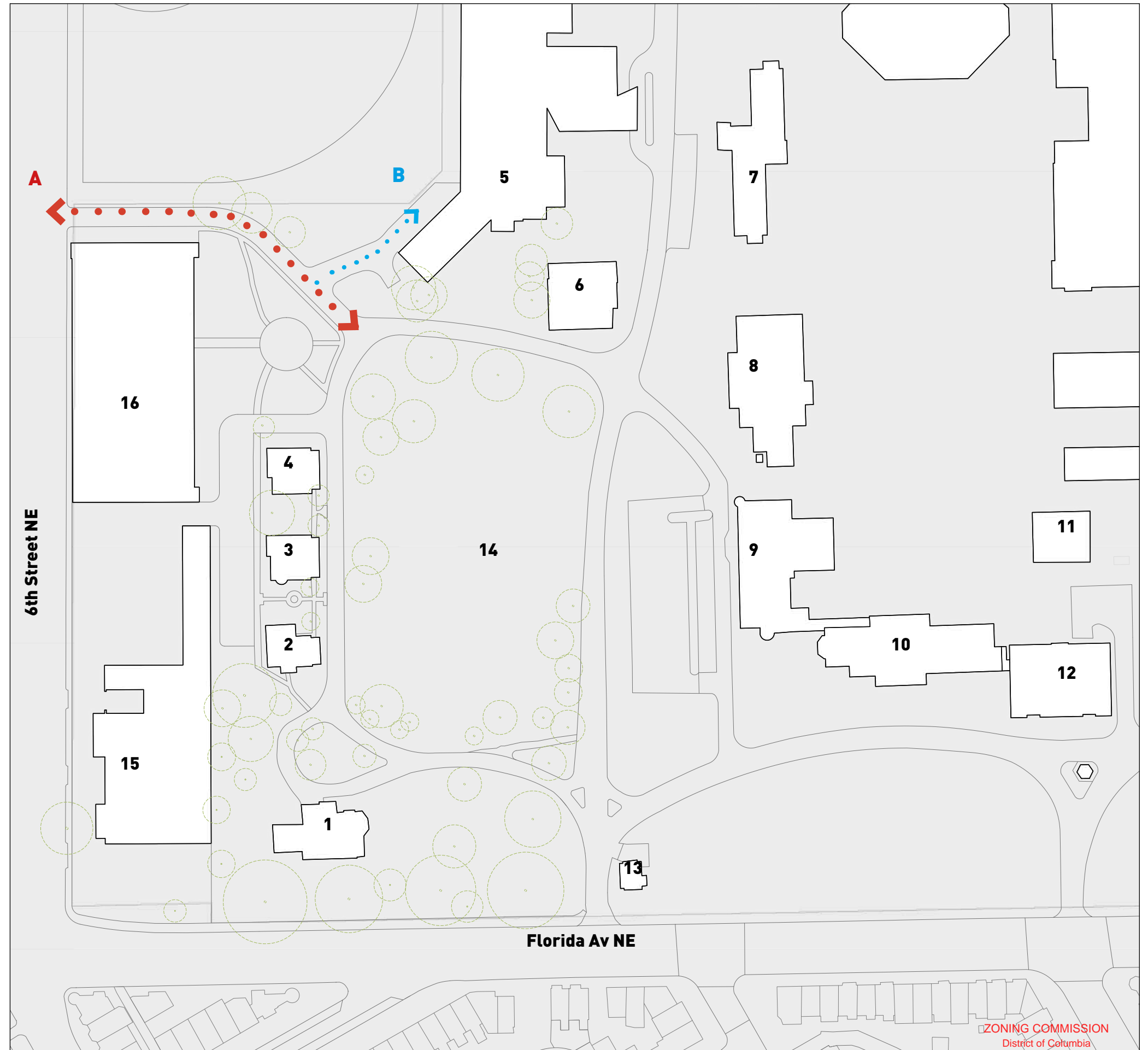

7.0 TAPSCOTT STREET ALIGNMENT - PROPOSED

Blue dashed line indicates extent of site plan shown to the right

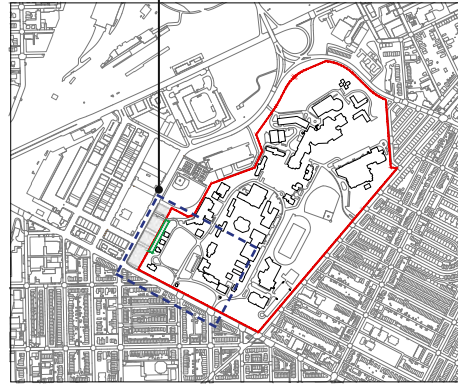

KEY

1. House 1
 2. Ballard House
 3. Fay House
 4. Denison House
 5. Kellogg Conference Center
 6. Peikoff Alumni House
 7. Peet Hall
 8. EMG Memorial Building
 9. College Hall
 10. Chapel Hall
 11. Dawes House
 12. Fowler Hall
 13. Gate Lodge
 14. Olmsted Green
 15. 6th St Parcel 1 Lot Development
 16. 6th St Parcel 2 Lot 2A1 Development
 17. 6th St Parcel 2 Lot 2A2 Development
 18. 6th St Parcel 2 Lot 2B Development
 19. Miller Memorial
 20. Creativity Way Project
 21. Conservatory *(subject to review)*
- A.** Proposed Tapscott St Realignment
- B.** Existing Service Access to Kellogg Hotel maintained



0' 20' 40' 80' 120'

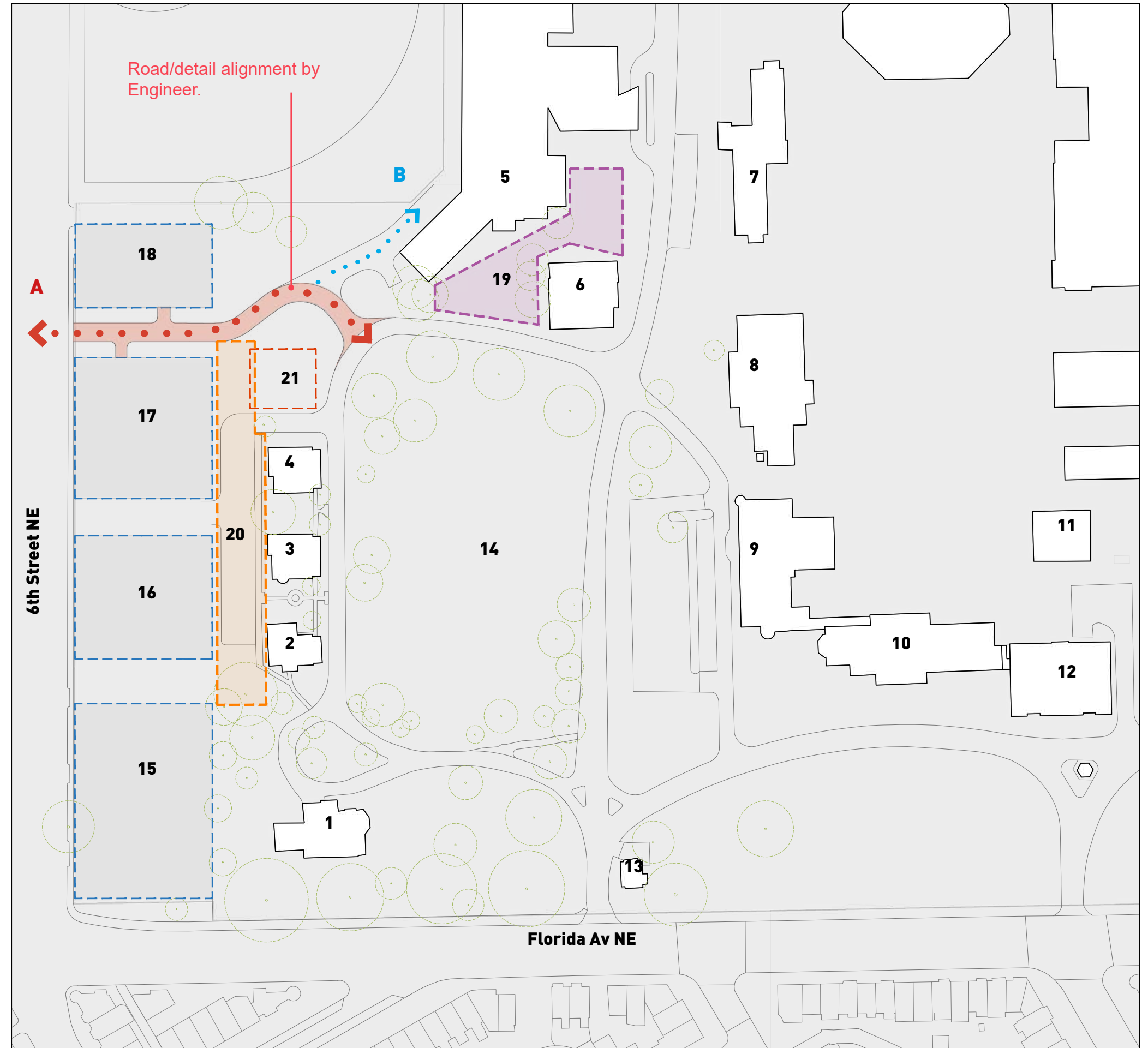

7.1 TAPSCOTT STREET ALIGNMENT - PROPOSED DELIVERY VEHICLE TRACKING

The diagrams below illustrate the proposed tracking route of a 40' delivery truck, entering Campus through Tapscott Street to make deliveries to Kellogg Conference Hotel loading area.

Diagram showing typical 40' truck used for deliveries to Kellogg Conference Hotel

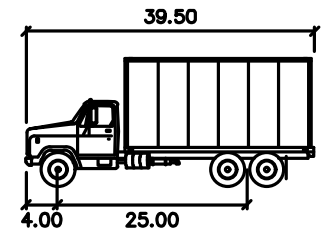

Note - Left-hand drawing on this page by Bowman. Right-hand drawing by HMCK with Bowman tracking overlay

SU-40	
	feet
Width	: 8.00
Track	: 8.00
Lock to Lock Time	: 6.0
Steering Angle	: 31.8

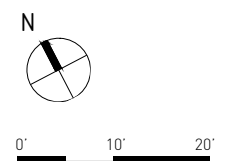
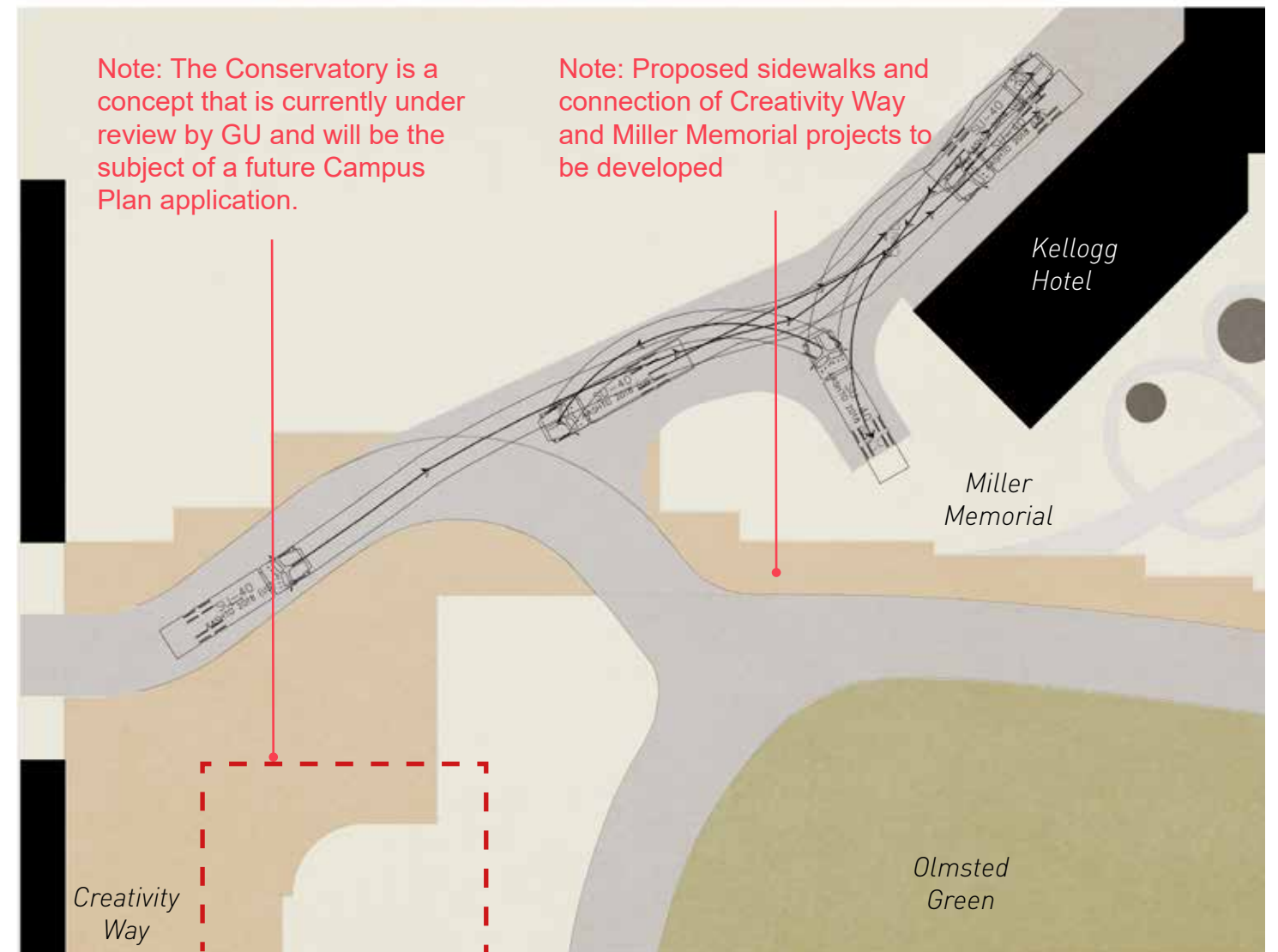
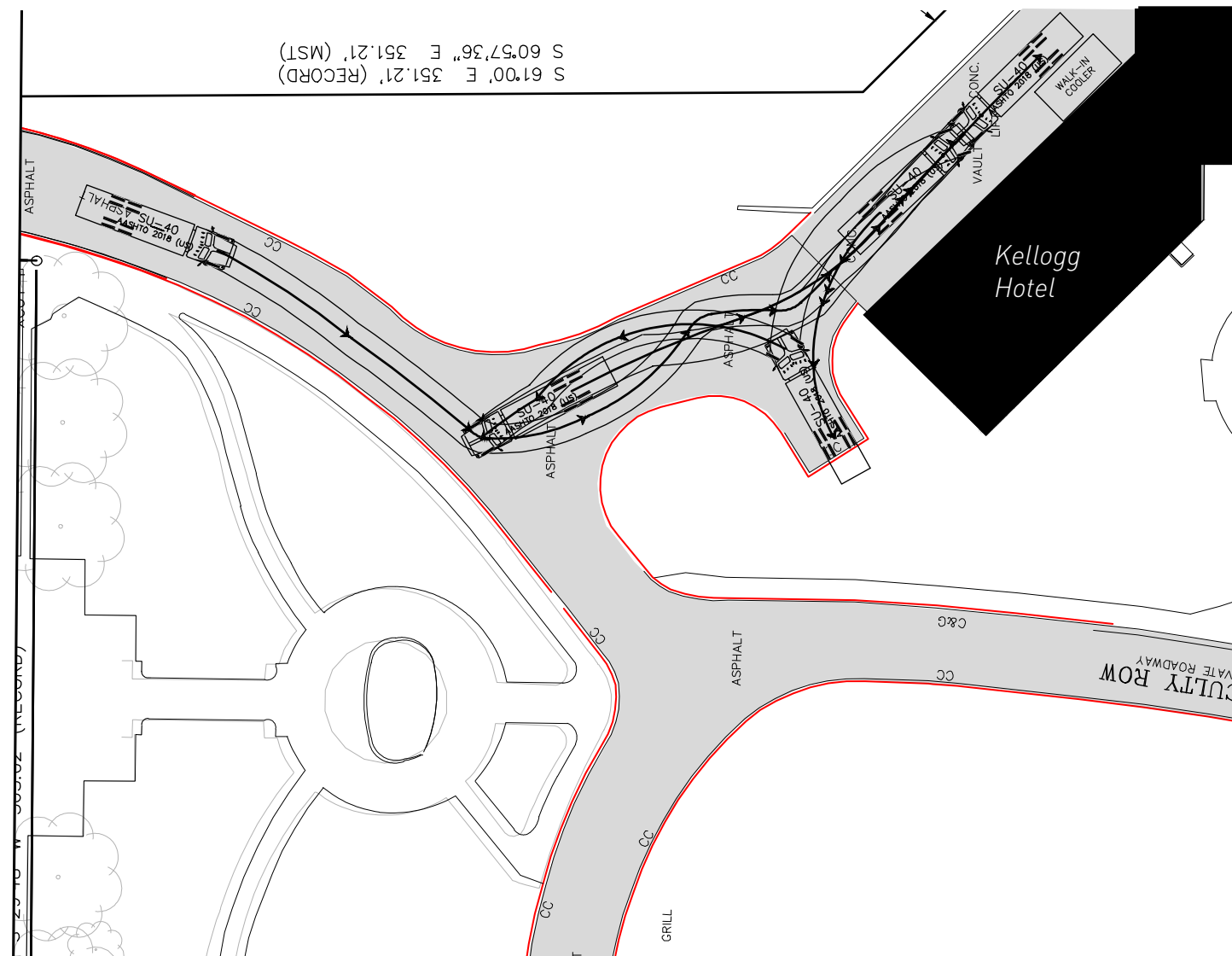

Existing Plan Above:
Tracking diagram showing existing Tapscott Street alignment

Proposed Plan Above:
Tracking diagram showing proposed Tapscott Street alignment

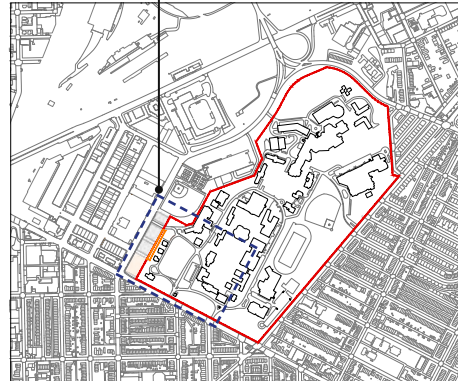

8.0 CAMPUS BOUNDARY ADJUSTMENT

Blue dashed line indicates extent of site plan shown to the right



KEY

1. House 1
2. Ballard House
3. Fay House
4. Denison House
5. Kellogg Conference Center
6. Peikoff Alumni House
7. Peet Hall
8. EMG Memorial Building
9. College Hall
10. Chapel Hall
11. Dawes House
12. Fowler Hall
13. Gate Lodge
14. Olmsted Green
15. 6th St Parcel 1
16. 6th St Parcel 2A1
17. 6th St Parcel 2A2
18. 6th St Parcel 2B
19. Miller Memorial
20. Creativity Way Project

-  Proposed footprint of Creativity Way (20,000SF)
-  Proposed boundary of the residentially-zoned portion of Gallaudet's campus

0' 20' 40' 80' 120'

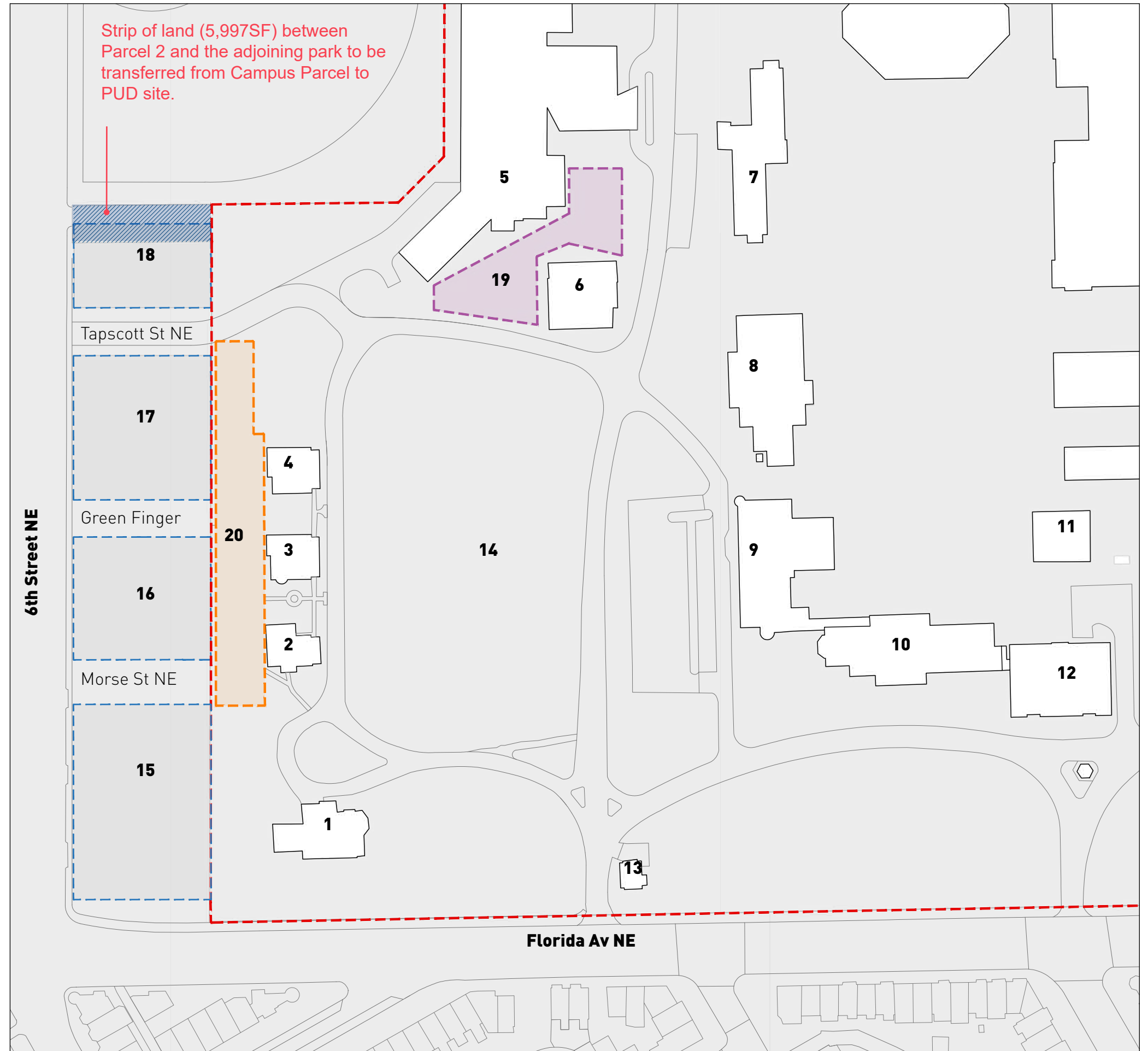

9.0 MILLER MEMORIAL

A series of visuals illustrating the artistic concept and design elements of Miller Memorial.

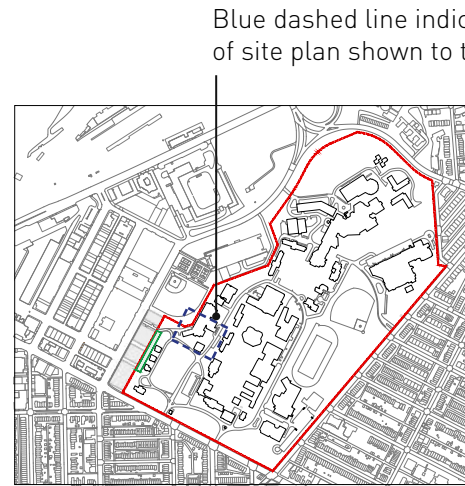

Blue dashed line indicates extent of site plan shown to the right

FREEDOM GARDEN
CONCEPT PLAN



Note - design / visualisation by MASS Design Group / TEN x TEN Landscape Architecture

9.1 MILLER MEMORIAL VISUALS

A series of visuals illustrating the artistic concept and design elements of Miller Memorial.



1

Note - design / visualisation by MASS Design Group / TEN x TEN Landscape Architecture

9.1 MILLER MEMORIAL VISUALS

A series of visuals illustrating the artistic concept and design elements of Miller Memorial.



2

Note - design / visualisation by MASS Design Group / TEN x TEN Landscape Architecture

9.1 MILLER MEMORIAL VISUALS

A series of visuals illustrating the artistic concept and design elements of Miller Memorial.



3

Note - design / visualisation by MASS Design Group / TEN x TEN Landscape Architecture

9.1 MILLER MEMORIAL VISUALS

A series of visuals illustrating the artistic concept and design elements of Miller Memorial.



4

Note - design / visualisation by MASS Design Group / TEN x TEN Landscape Architecture

